

SERIES MP

MODEL  
MPY1 / MPY2  
MPY3

Angle Seat Globe Valve



Valve Pressure Rating	PN40 (1/2"-1") PN25 (1/4"-2")
Valve Piloting Type	Pneumatics (Spring return)
Control Function	Normally closed
Material	ASTM A351-CF8M
Temperature Range	-10°C ~ +180°C
Control Pressure	4 ~ 10 Bar
Seat	PTFE
Additional Features	<ul style="list-style-type: none"> <li>• Available connections: Threaded, Flanged, T-Clamp</li> <li>• NAMUR solenoid mounting pad</li> </ul>

MATERIALS LIST

NO.	PART NAME	QTY	MATERIAL
1	ACTUATOR BODY	1	PA66-GF30%
2	ACTUATOR COVER	1	PA66-GF30%
3	TRANSPARENT CUP	1	PC
4	MOVABLE DISPLAYER	1	PA66-GF30%
5	TUBE	1	SUS316
6	PISTON	1	BRASS
7	STEM	1	SUS316
8	PLOG	1	SUS316
9	GLAND NUT	1	BRASS
10	SPRING	1	SWC
11	SPRING	1	SUS304
12	V-RING PACKING	2	VITON
13	V-RING PACKING	1	PTFE
14	V-RING PACKING	1	PTFE
15	BEARING	1	PTFE
16	BEARING	1	PTFE
17	SEAT	1	PTFE
18	DOWEL PIN	1	SUS316
19	END SEAL	1	TFM4215
19A	END O-RING	1	EPDM
20	VALVE BODY	1	SUS316
21	SEAT NUT	1	SUS316
22	PISTON SEAL	1	NBR
23	TUBE O-RING	1	VITON
24	TUBE O-RING	1	VITON
25	TUBE O-RING	1	VITON
26	STEM O-RING	1	VITON
27	BODY O-RING	1	NBR
28	COVER O-RING	1	NBR
29	STEM SEAL	1	VITON
30	WASHER	2	BRASS
31	STEM WASHER	2	SUS304
32	STEM NUT	1	SUS304
33	BELLEVILLE WASHER 11/2"-2"	1	SUS304
34	TUBE O-RING	1	VITON
35	SPRING (1/2"-2")	1	SWC

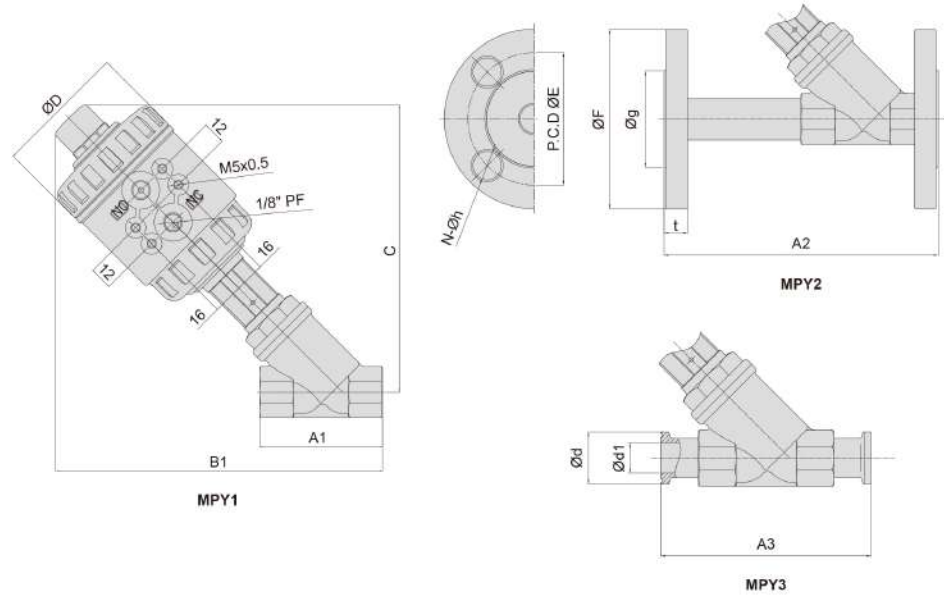
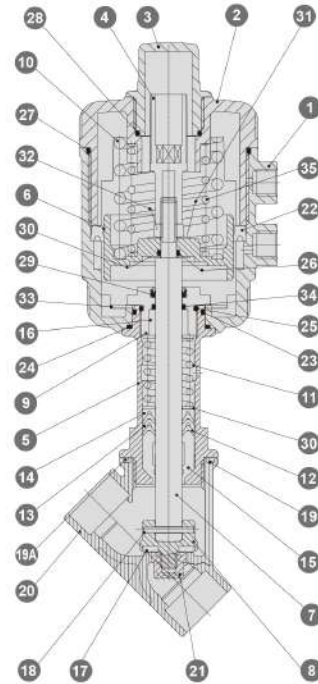

DIMENSIONS (mm)

SIZE	A1	A2	A3	B1	C	ØD	Ød	Ød1	ØE	ØF	Øg	N-Øh	t	Ø Control head	P control bar		P operating bar	
															Min	Max	Max	
1/2"	10K								70	95	51	4-15	12.5					
	PN16	65	145	113	173	152	70	25	9.5	65	95	45	4-14	14	50	4	10	11
	150LB									60.3	89	35	4-16	11.2				
3/4"	10K								75	100	56	4-15	14.5					
	PN16	75	150	130	179	157	70	25	15.9	75	105	58	4-14	16	50	4	10	11
	150LB									69.9	96.4	43	4-16	12.7				
1"	10K								90	125	67	4-19	14.3					
	PN16	90	180	140	209	182	84	50.4	22.2	85	115	68	4-14	16	63	4	10	11
	150LB									79.4	108	50.8	4-16	14.3				
1 1/4"	10K								100	135	76	4-19	16.3					
	PN16	110	190	-	214	192	84	-	-	100	140	78	4-18	16	63	4	10	11
	150LB									88.9	117.5	63.5	4-16	15.8				
1 1/2"	10K								105	140	81	4-19	16.5					
	PN16	120	220	170	250	219	115	50.4	35	110	150	88	4-18	16	90	4	8	11
	150LB									98.4	127	73	4-16	17.4				
2"	10K								120	155	96	4-19	16.5					
	PN16	150	235	212	267	226	115	64	47.5	125	165	102	4-18	18	90	4	8	11
	150LB									120.7	152.4	92	4-19	19				

SERIES 10  
SERIES 20  
SERIES 30  
SERIES 70  
SERIES 85  
SERIES 90  
SERIES 95  
SERIES MP  
OTHER VALVES AND VALVE PARTS  
PRESSURE TEMPERATURE RATINGS