

# SERIES 95

## MODEL 95K

3-Piece High Pressure  
Ball Valve  
Compression Fitting / Tube



<b>Pressure Rating</b>	2000WOG
<b>Material</b>	ASTM A351-CF8M
<b>Seat</b>	TFM1600
<b>Bore Type</b>	Reduced bore
<b>Additional Features</b>	<ul style="list-style-type: none"> <li>• ISO 5211 direct mounting pad</li> <li>• Silver plated nut</li> <li>• Heat treated ferrule</li> </ul>

### MATERIALS LIST

NO.	PART NAME	QTY	MATERIAL
1	BODY	1	CF8M
2	END CAP	2	CF8M
3	BALL	1	SUS316
4	STEM	1	SUS316
5	PACKING	2	PTFE
6	SEAT	2	TFM1600
7	STEM SEAL	1	R.PTFE
8	V-RING PACKING	1SET	PTFE
9	BUSHING	1	50%S.S.POWDER FILLED PTFE
10	O-RING	1	VITON
11	STEM NUT	2	SUS304
12	GLAND	1	SUS304
13	BELLEVILLE WASHER	2	SUS304
14	BOLT	4	SUS304
15	WASHER	4	SUS304
16	BOLT NUT	4	SUS304
17	LOCK SADDLE	1	SUS304
18	WASHER	1	SUS304
19	HANDLE	1	SUS304
20	HANDLE SLEEVE	1	VINYL
21	STOP PIN	1	SUS304
22	STOP PIN NUT	1	SUS304

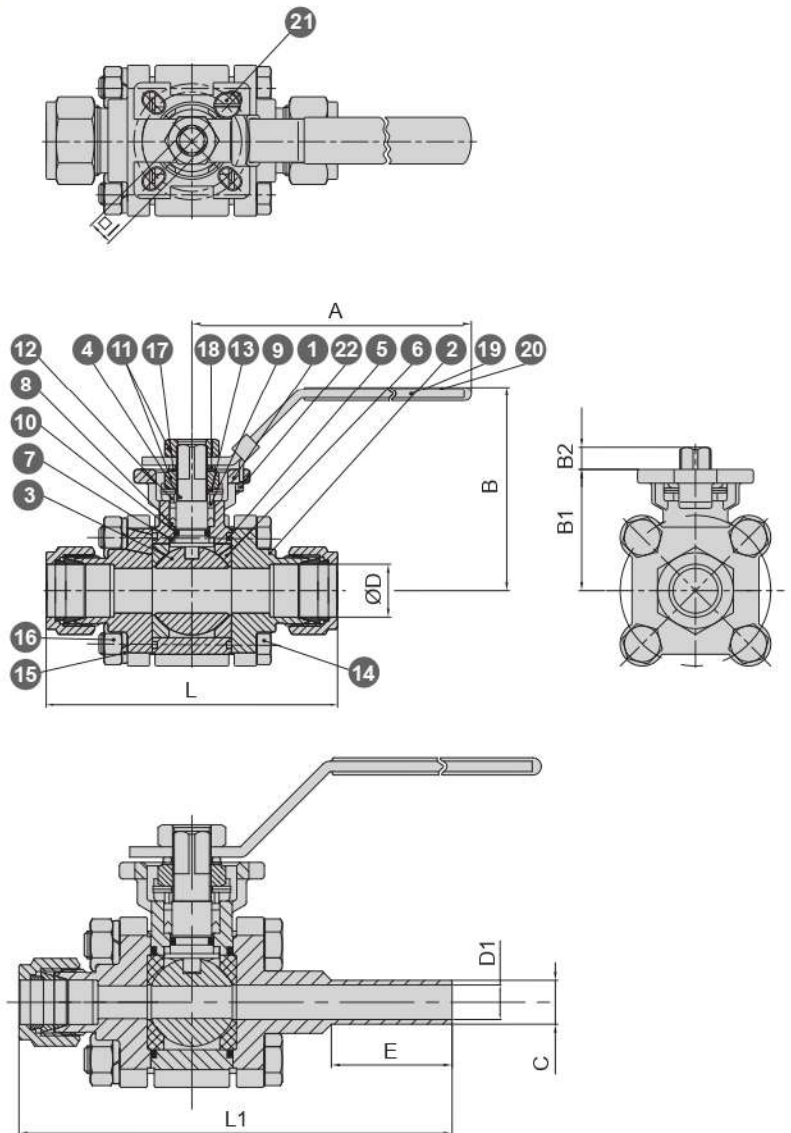

### DIMENSIONS (mm)

SIZE	A	B	B1	B2	ØD	□	L	ISO 5211	L1	E	C	D1
1/4"	128	70.8	40.5	9	6.49	9	95.1	F03 F04	-	-	-	-
3/8"	128	70.8	40.5	9	9.7	9	96.2	F03 F04	-	-	-	-
1/2"	128	70.8	40.5	9	12.9	9	102.2	F03 F04	125.5	35	12.7	10
3/4"	128	74.1	43.7	9	19.2	9	102.2	F03 F04	130.6	41.3	19.05	15.75

SERIES 10

SERIES 20

SERIES 30

SERIES 70

SERIES 85

SERIES 90

SERIES 95

SERIES  
MPY / MP

OTHER VALVES  
AND  
VALVES PARTS

PRESSURE  
TEMPERATURE  
RATINGS